

SureTrend[®] Quantification Calculator for the BAX[®] System

SureTrend® Quant

Getting Started

1. Following the completion of the BAX® System Real-Time PCR result analysis, ensure the file is saved in a known location as a .bax file.

Log into SureTrend.

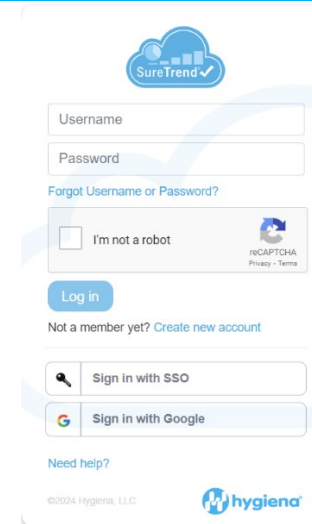

Quant Setup (Only at First Use of SureTrend Quant)

2. To log into a SureTrend account with the Premium package, navigate to 'Settings' (see **a** on the image to the right).

Under 'Account Management' (see **b**), ensure that the Package type is set to 'Premium' (see **c**).

If you have a starter package, you will need to click on the 'Upgrade' button (see **d**) and complete a form to access the Quant Online software.

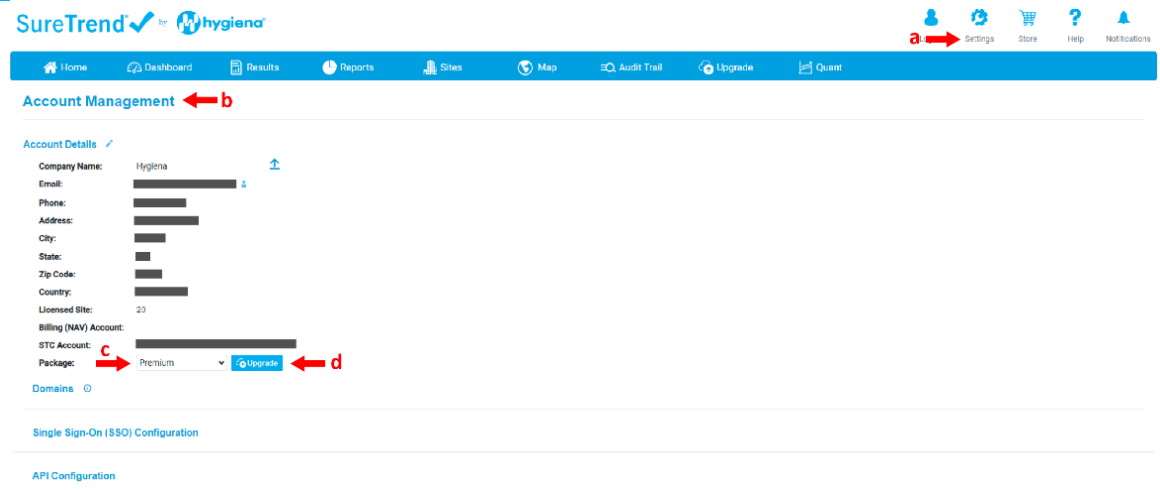

- To enable Quant, navigate to the 'Sites' tab (see a).
 Select a site (see b).
 Click on the 'Site Settings' tab (see c).
 Under 'Product Selections' (see d), click on 'PCR' (see e).
 Check the 'Quant' checkbox (see f).
 Your account is now set up to use Quant in future data analyses.

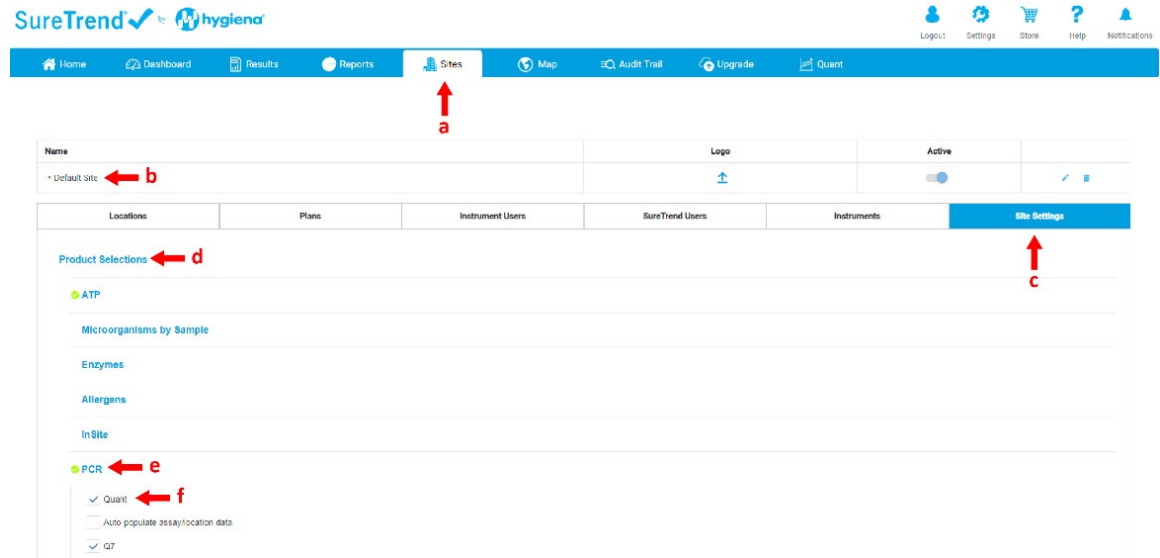

File Upload

After registering with SureTrend, BAX Q7 desktop computers with software 5.0 or later can be enabled to automatically upload files to SureTrend. Files may also be uploaded manually by following the steps below.

- To upload files manually, navigate to the 'Quant' tab (see a).
 Click on the 'Upload Files' button (see b).

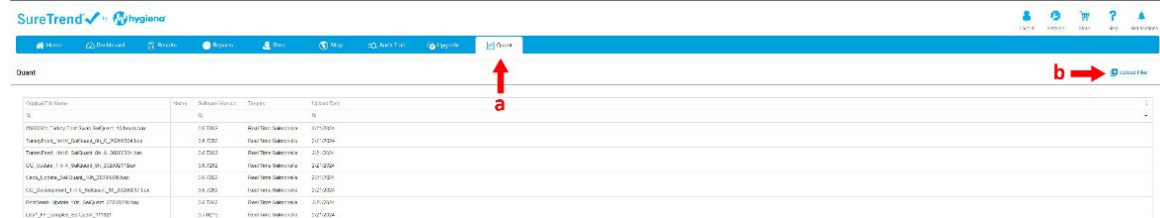



- Select the site from the dropdown list (see **a**).
 Select 'Bax (.bax)' for the File Type (see **b**)
 Ensure the box is checked for the question, 'Is this Quant upload?' (see **c**).
 Press the 'Select file(s) to upload' button (see **d**).
 Select .bax file(s) from your saved location.
Note: Multiple files can be uploaded at once.

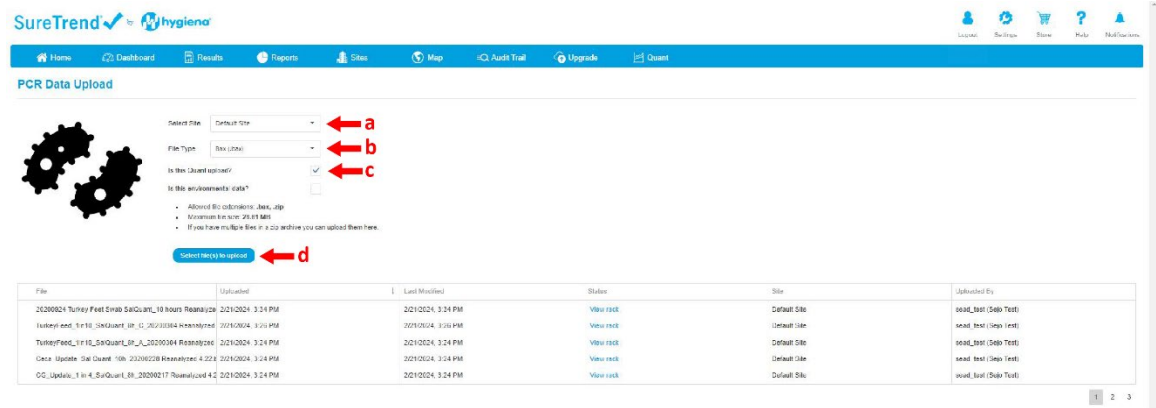

- Press the 'Upload' button (see **a**) to upload all the files that appear under the 'Upload' button.
 Files can be uploaded individually by clicking on the upload icon next to the file name (see **b**).
 Files can be removed from the list by clicking on the delete icon next to the file name (see **c**).

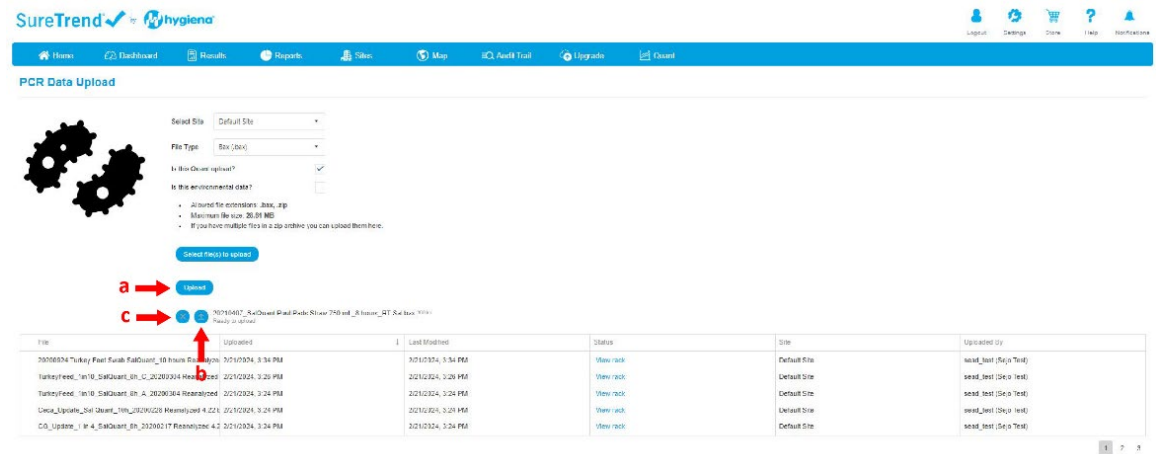



View and Export BAX Quant Results

- When the Status changes from 'Uploading...' to 'View rack', the file has been uploaded successfully (see **a**).

Click on "View rack" to open the PCR results table.

PCR Data Upload

File Name: Full QR
 File Type: Bin (BAX)
 Is this Quant uploaded?
 Is this environmental data?

20210407_SAMQuant PostPods Straw 750 ml_0 hours_RT Salbac (1) (1)

File	Uploaded	Last Modified	Status	Site	Uploaded By
70191417_FullQR PostPods Straw 750 ml_0 hours_RT 10/10/2024 10:08 AM	20240204 10:08 AM	20240204 10:08 AM	Uploading... View rack	Default Site	seac_test (Seo Test)
20200224_Turkey Foot Evid SalQuant 10 hours Reanalysis 2/2/2024 3:34 PM	20240204 3:34 PM	20240204 3:34 PM	View rack	Default Site	seac_test (Seo Test)
TurkeyFeed_Lin10_SAMQuant_BA_20200904 Reanalysis 2/2/2024 3:24 PM	20240204 3:24 PM	20240204 3:24 PM	View rack	Default Site	seac_test (Seo Test)
TurkeyFeed_Lin10_SAMQuant_BA_20200904 Reanalysis 2/2/2024 3:24 PM	20240204 3:24 PM	20240204 3:24 PM	View rack	Default Site	seac_test (Seo Test)
Deck_UperM_SAM Quant_10h_20200220 Reanalysis 2/2 2/2/2024 3:24 PM	20240204 3:24 PM	20240204 3:24 PM	View rack	Default Site	seac_test (Seo Test)

- Select the rows you want to view in more detail by checking the boxes in the first column (see **a**). The rows will become highlighted in gray.

Click on the 'Quant results' button (see **b**).

Results

Original File Name	Result State	Result ID	Time of Detection	Site	Unit Number	Location	Description	Quant Y/N	Mask Description	Operator ID	Name	Control Result	Control Status	Array	Kit Lot Number	Batch
Original File Name: L001 SalQuant_BH GravelPods Time Detection: 7/9/2020 4:21 PM	Positive	202396	7/9/2020 4:21 PM	Q/Timeline 0	1	LOC1 Sa-Quant 0 hour						Integrated	Real Time SalmoSella			Q1-0302 Item
	Positive	202396	7/9/2020 4:21 PM	Q/Timeline 0	2	LOC1 Sa-Quant 0 hour						Integrated	Real Time SalmoSella			Q1-0302 Item
	Positive	202396	7/9/2020 4:21 PM	Q/Timeline 0	3	LOC1 Sa-Quant 0 hour						Integrated	Real Time SalmoSella			Q1-0302 Item
	Positive	202396	7/9/2020 4:21 PM	Q/Timeline 0	4	LOC1 Sa-Quant 0 hour						Integrated	Real Time SalmoSella			Q1-0302 Item
	Positive	202396	7/9/2020 4:21 PM	Q/Timeline 0	5	LOC1 Sa-Quant 0 hour						Integrated	Real Time SalmoSella			Q1-0302 Item
	Positive	202396	7/9/2020 4:21 PM	Q/Timeline 0	6	LOC1 Sa-Quant 0 hour						Integrated	Real Time SalmoSella			Q1-0302 Item
	Positive	202396	7/9/2020 4:21 PM	Q/Timeline 0	12	LOC1 Sa-Quant 0 hour						Integrated	Real Time SalmoSella			Q1-0302 Item
	Positive	202396	7/9/2020 4:21 PM	Q/Timeline 0	13	LOC1 Sa-Quant 0 hour						Integrated	Real Time SalmoSella			Q1-0302 Item
	Positive	202441	7/9/2020 4:21 PM	Q/Timeline 0	14	LOC1 Sa-Quant 0 hour						Integrated	Real Time SalmoSella			Q1-0302 Item
	Positive	202442	7/9/2020 4:21 PM	Q/Timeline 0	15	LOC1 Sa-Quant 0 hour						Integrated	Real Time SalmoSella			Q1-0302 Item
	Positive	202443	7/9/2020 4:21 PM	Q/Timeline 0	16	LOC1 Sa-Quant 0 hour						Integrated	Real Time SalmoSella			Q1-0302 Item
	Positive	202447	7/9/2020 4:21 PM	Q/Timeline 0	19	LOC1 Sa-Quant 0 hour						Integrated	Real Time SalmoSella			Q1-0302 Item
	Positive	202448	7/9/2020 4:21 PM	Q/Timeline 0	20	LOC1 Sa-Quant 0 hour						Integrated	Real Time SalmoSella			Q1-0302 Item
	Positive	202448	7/9/2020 4:21 PM	Q/Timeline 0	21	LOC1 Sa-Quant 0 hour						Integrated	Real Time SalmoSella			Q1-0302 Item
	Positive	202448	7/9/2020 4:21 PM	Q/Timeline 0	22	LOC1 Sa-Quant 0 hour						Integrated	Real Time SalmoSella			Q1-0302 Item
	Positive	202448	7/9/2020 4:21 PM	Q/Timeline 0	23	LOC1 Sa-Quant 0 hour						Integrated	Real Time SalmoSella			Q1-0302 Item
	Positive	202448	7/9/2020 4:21 PM	Q/Timeline 0	24	LOC1 Sa-Quant 0 hour						Integrated	Real Time SalmoSella			Q1-0302 Item
	Positive	202448	7/9/2020 4:21 PM	Q/Timeline 0	25	LOC1 Sa-Quant 0 hour						Integrated	Real Time SalmoSella			Q1-0302 Item
	Positive	202448	7/9/2020 4:21 PM	Q/Timeline 0	26	LOC1 Sa-Quant 0 hour						Integrated	Real Time SalmoSella			Q1-0302 Item
	Positive	202448	7/9/2020 4:21 PM	Q/Timeline 0	27	LOC1 Sa-Quant 0 hour						Integrated	Real Time SalmoSella			Q1-0302 Item
	Positive	202448	7/9/2020 4:21 PM	Q/Timeline 0	28	LOC1 Sa-Quant 0 hour						Integrated	Real Time SalmoSella			Q1-0302 Item
	Positive	202448	7/9/2020 4:21 PM	Q/Timeline 0	29	LOC1 Sa-Quant 0 hour						Integrated	Real Time SalmoSella			Q1-0302 Item
	Positive	202448	7/9/2020 4:21 PM	Q/Timeline 0	30	LOC1 Sa-Quant 0 hour						Integrated	Real Time SalmoSella			Q1-0302 Item
	Positive	202448	7/9/2020 4:21 PM	Q/Timeline 0	31	LOC1 Sa-Quant 0 hour						Integrated	Real Time SalmoSella			Q1-0302 Item
	Positive	202448	7/9/2020 4:21 PM	Q/Timeline 0	32	LOC1 Sa-Quant 0 hour						Integrated	Real Time SalmoSella			Q1-0302 Item
	Positive	202448	7/9/2020 4:21 PM	Q/Timeline 0	33	LOC1 Sa-Quant 0 hour						Integrated	Real Time SalmoSella			Q1-0302 Item
	Positive	202448	7/9/2020 4:21 PM	Q/Timeline 0	34	LOC1 Sa-Quant 0 hour						Integrated	Real Time SalmoSella			Q1-0302 Item
	Positive	202448	7/9/2020 4:21 PM	Q/Timeline 0	35	LOC1 Sa-Quant 0 hour						Integrated	Real Time SalmoSella			Q1-0302 Item
	Positive	202448	7/9/2020 4:21 PM	Q/Timeline 0	36	LOC1 Sa-Quant 0 hour						Integrated	Real Time SalmoSella			Q1-0302 Item
	Positive	202448	7/9/2020 4:21 PM	Q/Timeline 0	37	LOC1 Sa-Quant 0 hour						Integrated	Real Time SalmoSella			Q1-0302 Item
	Positive	202448	7/9/2020 4:21 PM	Q/Timeline 0	38	LOC1 Sa-Quant 0 hour						Integrated	Real Time SalmoSella			Q1-0302 Item
	Positive	202448	7/9/2020 4:21 PM	Q/Timeline 0	39	LOC1 Sa-Quant 0 hour						Integrated	Real Time SalmoSella			Q1-0302 Item
	Positive	202448	7/9/2020 4:21 PM	Q/Timeline 0	40	LOC1 Sa-Quant 0 hour						Integrated	Real Time SalmoSella			Q1-0302 Item
	Positive	202448	7/9/2020 4:21 PM	Q/Timeline 0	41	LOC1 Sa-Quant 0 hour						Integrated	Real Time SalmoSella			Q1-0302 Item
	Positive	202448	7/9/2020 4:21 PM	Q/Timeline 0	42	LOC1 Sa-Quant 0 hour						Integrated	Real Time SalmoSella			Q1-0302 Item
	Positive	202448	7/9/2020 4:21 PM	Q/Timeline 0	43	LOC1 Sa-Quant 0 hour						Integrated	Real Time SalmoSella			Q1-0302 Item
	Positive	202448	7/9/2020 4:21 PM	Q/Timeline 0	44	LOC1 Sa-Quant 0 hour						Integrated	Real Time SalmoSella			Q1-0302 Item
	Positive	202448	7/9/2020 4:21 PM	Q/Timeline 0	45	LOC1 Sa-Quant 0 hour						Integrated	Real Time SalmoSella			Q1-0302 Item
	Positive	202448	7/9/2020 4:21 PM	Q/Timeline 0	46	LOC1 Sa-Quant 0 hour						Integrated	Real Time SalmoSella			Q1-0302 Item
	Positive	202448	7/9/2020 4:21 PM	Q/Timeline 0	47	LOC1 Sa-Quant 0 hour						Integrated	Real Time SalmoSella			Q1-0302 Item
	Positive	202448	7/9/2020 4:21 PM	Q/Timeline 0	48	LOC1 Sa-Quant 0 hour						Integrated	Real Time SalmoSella			Q1-0302 Item
	Positive	202448	7/9/2020 4:21 PM	Q/Timeline 0	49	LOC1 Sa-Quant 0 hour						Integrated	Real Time SalmoSella			Q1-0302 Item
	Positive	202448	7/9/2020 4:21 PM	Q/Timeline 0	50	LOC1 Sa-Quant 0 hour						Integrated	Real Time SalmoSella			Q1-0302 Item

9. In the rack view, select individual wells for analysis by clicking on the name (see **a**) or Select/Unselect All by clicking on the blue icon (see **d**) in the top right corner of the screen.

From the Quantification Matrix Selection under the rack view, select the industry name (see **b**) to open the list of matrices and select the matrix (see **c**).

Click on the blue icon (see **d**) in the top right corner of the screen and select 'Analyze' (see **e**) from the dropdown menu.

Quant Day1_FF_samples_SalQuant_111821

Quantification Matrix Selection

Name	Time Point	Report Unit Per Sample	Report Unit	Limit Of Quantification
Rinsate	5	LogCFU/Carcass	LogCFU/mL	1 CFU/mL
Rinsate (Low Level)	10	LogCFU/Carcass	LogCFU/mL	0.5 CFU/30 mL Sample
Ground Chicken 1.4	8	LogCFU/25g	LogCFU/g	1 CFU/g
Ground Chicken 1.6	8	LogCFU/25g	LogCFU/g	1 CFU/g
Ground Turkey 1.1	8	LogCFU/25g	LogCFU/g	1 CFU/g
Ground Turkey 1.4	8	LogCFU/25g	LogCFU/g	1 CFU/g
Ground Turkey 1.6	8	LogCFU/25g	LogCFU/g	1 CFU/g

10. The graphical results of the selected wells will be displayed.

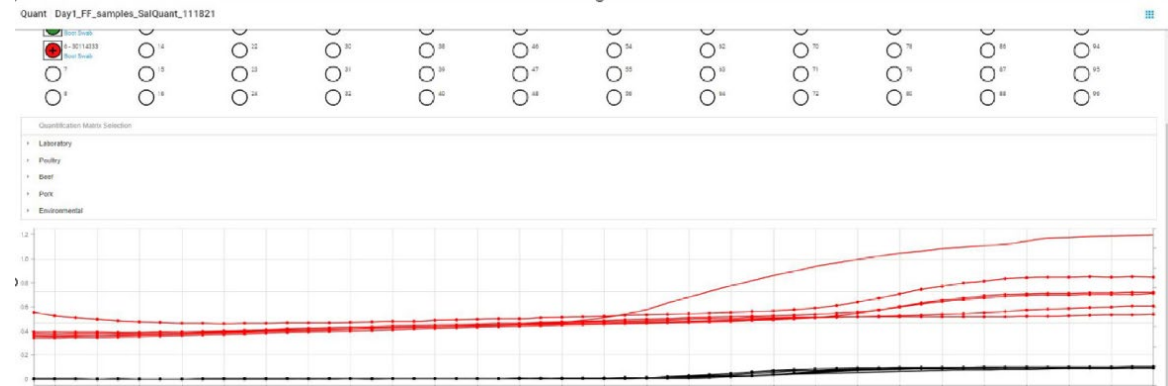



11. View the table under the graphs for additional details and to export Quant results.

Estimations (Estimated Log CFU per Sample) (see **a**) will be displayed in multiple unit formats to be used at the user's discretion.

Click on the Column Chooser icon (see **b**) to open the selection box (see **c**) and choose the data that you want to export.

Click on the export button (see **d**) to download a .csv file.

Quant TurkeyFeed_tin10_SalQuant_8h_C_20200304.bax

Sample ID	PCR kit	Status	Lot Number	CFU	Estimated Log CFU per Sample	Report Unit Per Sample	Estimated Log CFU per Unit	Report Unit	Limit Of Quantification	CFU Per Sample	CFU Per Unit	Status
1	81_8_0	Real Time Salmonella	Feed	201919K	0	Quant Negative	LogCFU25g	Quant Negative	LogCFU/g	10 CFU/g	Quant Negative	Quant Negative
2	81_8_0	Real Time Salmonella	Feed	201919K	0	Quant Negative	LogCFU25g	Quant Negative	LogCFU/g	10 CFU/g	Quant Negative	Quant Negative
3	81_8_0	Real Time Salmonella	Feed	201919K	0	Quant Negative	LogCFU25g	Quant Negative	LogCFU/g	10 CFU/g	Quant Negative	Quant Negative
4	81_8_0	Real Time Salmonella	Feed	201919K	0	Quant Negative	LogCFU25g	Quant Negative	LogCFU/g	10 CFU/g	Quant Negative	Quant Negative
5	81_8_0	Real Time Salmonella	Feed	201919K	0	Quant Negative	LogCFU25g	Quant Negative	LogCFU/g	10 CFU/g	Quant Negative	Quant Negative
6	81_4_0	Real Time Salmonella	Feed	201919K	30.9	5.5	LogCFU25g	< 10 CFU/g	LogCFU/g	10 CFU/g	314674	12547
7	82_4_0	Real Time Salmonella	Feed	201919K	31.4	6.32	LogCFU25g	< 10 CFU/g	LogCFU/g	10 CFU/g	29790	8318
8	83_4_0	Real Time Salmonella	Feed	201919K	31	6.46	LogCFU25g	< 10 CFU/g	LogCFU/g	10 CFU/g	28327	1815
9	82_8_0	Real Time Salmonella	Feed	201919K	0	Quant Negative	LogCFU25g	Quant Negative	LogCFU/g	10 CFU/g		
10	82_8_0	Real Time Salmonella	Feed	201919K	0	Quant Negative	LogCFU25g	Quant Negative	LogCFU/g	10 CFU/g		
11	82_8_0	Real Time Salmonella	Feed	201919K	0	Quant Negative	LogCFU25g	Quant Negative	LogCFU/g	10 CFU/g		
12	82_8_0	Real Time Salmonella	Feed	201919K	0	Quant Negative	LogCFU25g	Quant Negative	LogCFU/g	10 CFU/g		
13	82_8_0	Real Time Salmonella	Feed	201919K	0	Quant Negative	LogCFU25g	Quant Negative	LogCFU/g	10 CFU/g		
14	81_4_0	Real Time Salmonella	Feed	201919K	30.3	5.77	LogCFU25g	< 10 CFU/g	LogCFU/g	10 CFU/g		
15	82_4_0	Real Time Salmonella	Feed	201919K	31.7	6.21	LogCFU25g	< 10 CFU/g	LogCFU/g	10 CFU/g		
16	83_4_0	Real Time Salmonella	Feed	201919K	32.3	4.95	LogCFU25g	< 10 CFU/g	LogCFU/g	10 CFU/g		

Technical Assistance

For detailed troubleshooting on the BAX System instrument, see the BAX System Q7 User's Guide. For instructions for specific matrices and pathogen targets when using the BAX System, see the *Quantification and Limits Manual*. Guides and manuals are available at www.hygienea.com/documents.

If you have any additional questions or comments on the BAX System or quantification procedures, contact Hygienea Diagnostics Support by email at diagnostics.support@hygienea.com.